

DATASHEET

# Rockfon® Eclipse Customised

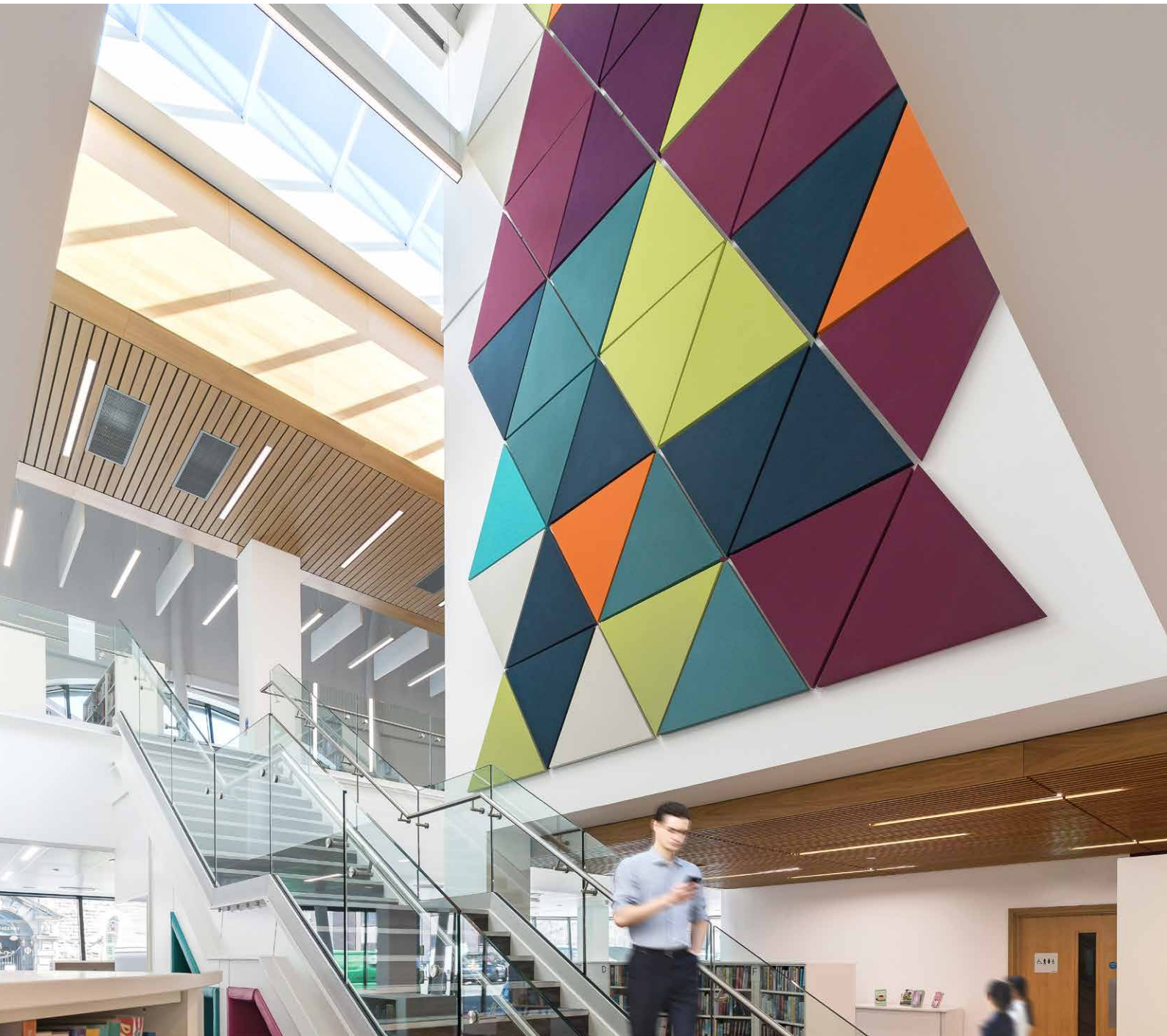

**Sounds Beautiful**

# Rockfon® Eclipse Customised





- Innovative and aesthetically pleasing frameless acoustic island comes in a smooth, matt surface with an unlimited custom colour range using NCS
- Rockfon Eclipse Customised is available in an unlimited variety of shapes, allowing for unique design freedom to inspire and enhance your interior design scheme
- Quick and easy to install, Rockfon Eclipse Customised can be used alone or where a traditional suspended ceiling cannot be installed
- Perfect for thermal mass installations with rear surface providing excellent heat and light reflection

## Product Description

- Stone wool island
- Visible side: smooth custom-coloured, matt fleece
- Rear side: white backing fleece
- Painted edges

## Application Areas

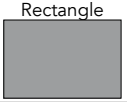
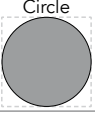
- Retail
- Education
- Office
- Leisure

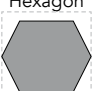
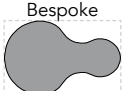
Edge detail	Shapes	Module size (mm)	Approximate weight (kg/unit)	Recommended installation System	Recycled content	Cradle to Cradle Certified®	A1-A3 Production stage impact (kg CO <sub>2</sub> eq/m <sup>2</sup> )*	A1-C4 Full life cycle impact (kg CO <sub>2</sub> eq/m <sup>2</sup> )*
A	Square 	1160 x 1160 x 40	9	Rockfon® System Eclipse Island™	39%		6.31	8.21
	Rectangle 	1760 x 1160 x 40	13	Rockfon® System Eclipse Island™				
	Circle 	800 x 800 x 40	3	Rockfon® System Eclipse Island™				
		1160 x 1160 x 40	7	Rockfon® System Eclipse Island™				
	Triangle 	1160 x 1005 x 40	4	Rockfon® System Eclipse Island™				
	Hexagon 	1160 x 1006 x 40	6	Rockfon® System Eclipse Island™				
	Bespoke 	- x - x 40	-	Rockfon® System Eclipse Island™				

Free-form sizes bigger than 2400 length or 1200 width will be produced as two halves.

Contact us for special shapes, sizes, two-sided painted Eclipse Customised, lead times and minimum order quantities.

\* For full environmental impact disclosure, see our product EPDs available on [rockfon.link/int-epd](https://rockfon.link/int-epd). Due to differences in calculation methods and scenario assumptions, environmental impact values are generally not directly comparable between manufacturers.



## Performance



### Sound absorption

$A_{eq}$  (m<sup>2</sup>/item)

\* Distance between items greater or equal to 2000mm. Further acoustic data available; contact your local Rockfon technical support.

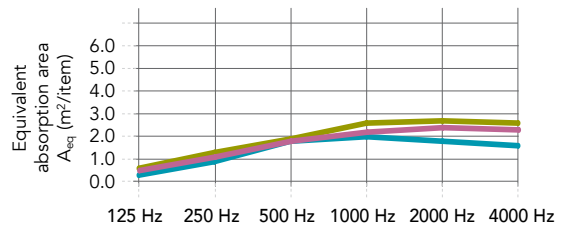

	125 Hz	250 Hz	500 Hz	1000 Hz	2000 Hz	4000 Hz
Square 1160 single item* (suspension height: 15mm)	0.3	0.9	1.8	2.0	1.8	1.6
Square 1160 single item* (suspension height: 500mm)	0.6	1.3	1.9	2.6	2.7	2.6
Square 1160 array of 6 items, 300mm distance (suspension height 500mm)	0.5	1.1	1.8	2.2	2.4	2.3



### Reaction to fire

A2-s1,d0



### Light reflection

Colour-dependent



### Humidity and sag resistance

Up to 100% RH.  
No visible deflection in high humidity.



### Cleaning

- Vacuum



### Hygiene

Stone wool provides no sustenance to microorganisms



### Recyclability

Fully recyclable stone wool



### Indoor environment

Rockfon ceiling products are classified in Class E1 in accordance with EN 13964 (EN 717-1).



### Material Health

All materials used in Rockfon products are screened against the list of substances restricted under REACH and do not contain substances of very high concern (SVHC). Rockfon stone wool fibres comply with the safe fibre EU regulation and hold an EUCEB certification.

The properties presented on this datasheet cover the majority of the NCS colour selection. For detailed information on specific NCS colours please contact Rockfon Customer Service.

Rockfon production facilities are certified according to the ISO 9001 and ISO 14001 management systems standards.

# Sounds Beautiful

